



# Caledonian

Military Cables

www.caledonian-cables.com

marketing@caledonian-cables.com

## MIL-W-16878/12 Type KK Wire 1C20AWG

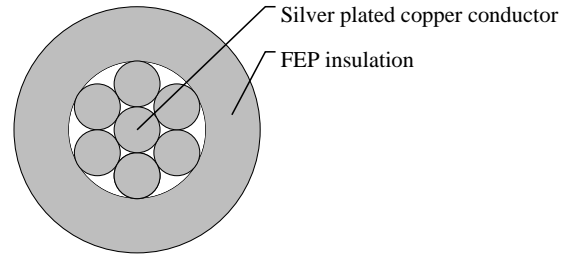
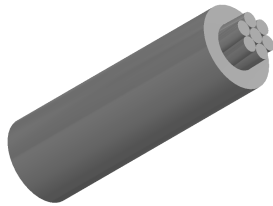

### APPLICATIONS

These FEP insulated single-core MIL-W-16878/12 (Type KK) wires are used in electronic equipment, motor leads and computer back panels.

### VOLTAGE RATING

1000V

### CABLE CONSTRUCTION

Conductor: Stranded Silver Plated Copper

(These wires also have tin-plated copper conductors for economy)

Insulation: Extruded FEP

Insulation Wall Thickness: 0.015"

### COLOUR CODE

Color Code: MIL-STD-104 (See page 12)

10 basic colors(BLK,BRN,RED,ORN,YEL,GRN,BLU,VIO,GRY,WHT)

### PHYSICAL AND THERMAL PROPERTIES

Temperature Range: -60°C to +200°C

### DIMENSION AND PARAMETERS

AWG Size	Conductor Stranding	Conductor Diameter	Conductor Diameter	Approx. Overall Diameter	Approx. Overall Diameter	Approx. Weight
		in	mm	in	mm	LBS/MFT
20	7/28	0.038	0.965	0.068	1.727	5.8